

W. R. MEADOWS.



# WATERPROOFING

# WATERPROOFING

Don't let moisture bully you...take back control.

### Ideal applications:

- Bridges
- Parking decks
- Plaza decks
- Structural slabs
- Vehicular, utility and pedestrian tunnel projects
- Hospitals
- Schools
- Office construction
- Commercial projects



If you need more information about how our products can help you prevent costly moisture migration, here are four quick and easy access points:

- Visit our comprehensive website: [www.wrmeadows.com](http://www.wrmeadows.com)
- Contact W. R. MEADOWS, INC. via email: [wrmil@wrmeadows.com](mailto:wrmil@wrmeadows.com)
- Call toll free: 1-800-342-5976
- Fax: 1-847-683-4544



For a full explanation of moisture movement in buildings, go to [www.wrmeadows.com](http://www.wrmeadows.com) and click on the "What's New" tab to request a copy of "Controlling Moisture Movement in Buildings: The Complete Approach."



**W. R. MEADOWS, INC.**  
 P.O. Box 338 • HAMPSHIRE, IL 60140-0338  
 Phone: 847.683.42100 • Fax: 847.683.4544  
[www.wrmeadows.com](http://www.wrmeadows.com)  
 HAMPSHIRE, IL / CARTERSVILLE, GA / YORK, PA  
 FORT WORTH, TX / BENICIA, CA / PONDINA, GA  
 GOODYEAR, AZ / MILTON, ON / ST. ALBERT, AB

Whatever your needs...  
**we have the solution.**



#BR-3

12/07-10M

PRINTED IN THE USA

# WATERPROOFING

Tired of being pushed around by water and moisture problems? Take back control with the **W. R. MEADOWS** complete moisture control package.

You've made a major investment in your building and that investment deserves the very best protection available. There's only one company that has consistently helped owners protect their buildings against the ingress of moisture.

For over 80 years, **W. R. MEADOWS** has been recognized as the leader in developing and producing quality products for the construction industry. We have built a coveted reputation among architects, engineers and contractors for producing the highest quality products backed by 80+ years of experience.

## How does moisture enter into my building?

Moisture is found in some form or another on every building site. The difference between a satisfied owner and a "problem" project is how you deal with this moisture. By developing systems that are designed to act together to provide complete protection, W. R. MEADOWS can help you design and build a structure that is protected.

## What makes up the total moisture control package?

W. R. MEADOWS manufactures a complete line of waterproofing and moisture control products. When these products are used in combination as a system, they ensure that you have complete control of moisture migration in your facility.

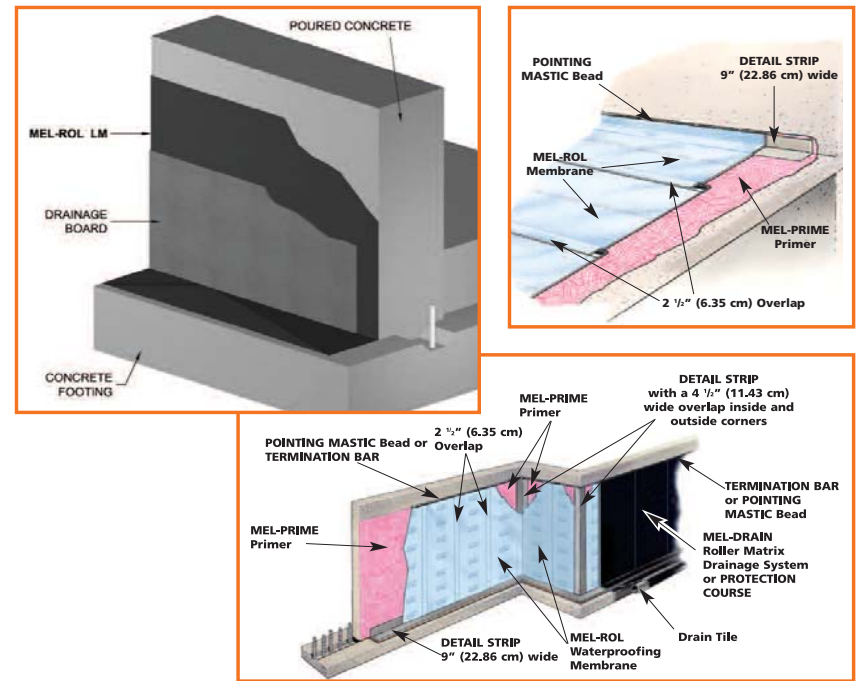

**MEL-ROL<sup>®</sup> LM** is a single-component, polymer-modified, cold-applied, water-based, liquid waterproofing membrane ideal for below-grade horizontal and vertical seamless waterproofing applications. We have taken the same high quality rubber polymers found in MEADOWS' successful MEL-ROL "peel and stick" membrane, and converted them into a heavy bodied, high solids, quick drying liquid membrane.

**MEL-ROL LM (ALL SEASON)** can be used on new and remedial waterproofing applications on concrete or masonry block substrates. Application can be performed in colder weather when water-based products cannot be used.

**MEL-ROL<sup>®</sup>** waterproofing system is a flexible, versatile, dependable, roll-type waterproofing membrane. It is composed of a nominally 56 mil thick layer of polymeric waterproofing membrane on a heavy-duty, 4 mil thick, cross-laminated polyethylene carrier film.

**MEL-PRIME<sup>®</sup>** is a ready-to-use primer available in solvent-based and water-based versions.

**PROTECTION COURSE** is a multi-ply, semi-rigid core composed of a mineral-fortified asphalt core formed between two outside layers of asphalt-impregnated reinforced mats.

**PERMINATOR<sup>®</sup>** underslab vapor barrier can also be used as a protection course for waterproofing membranes. The desired sheet lengths are cut to size and retained at the top of the waterproofing membrane by PERMINATOR TAPE or TERMINATION BAR. PERMINATOR 10 mil is also ideal for use over horizontal applications of MEL-ROL LM.

**MEL-DRAIN<sup>®</sup>** drainage board is designed to remove moisture from around footings and relieve hydrostatic head pressures. Eight versions are available.

**TERMINATION BAR** from W. R. MEADOWS is provided in 10' (3 m) lengths for your attachment needs.

**MEL-DEK<sup>®</sup>** waterproofing system provides an excellent waterproofing membrane for bridges, parking decks or other vehicular traffic structures to be overlaid with an asphaltic concrete wearing course. Ideal for repair, maintenance or new construction applications.