

CabForms® elevator interiors are ideal for new equipment or modernization projects. Complete, pre-engineered packages are available for all typical sizes of passenger and service cabs, single or double opening.

CabForms Series 1000 is a rugged stainless steel full panel version optimized for airports, educational institutions, parking structures and other public areas where maintainable aesthetics and resistance to abuse are important concerns.

What's Included

Standard Components:

- Wall Panels
- Bases
- Reveals
- Installation Hardware

Optional Components:

- Handrails
- Ceiling with Light Fixtures
- Emergency Lighting Power Supply

STANDARD MODELS: SERIES 1000

Model designations within each CabForms series are based upon the physical configurations of the wall panels:

Series 1000-A is the simplest panel configuration: Each main panel face is formed from a single piece of stainless steel in your choice of Forms+Surfaces standard finishes and patterns.

On Series 1000-B and 1000-C, the main panel faces are divided by accent areas that form a horizontal band around the cab interior. These accent areas may be specified in stainless steel finishes and/or patterns different from the main panels, allowing a multitude of additional design options. The only difference between 1000-B and 1000-C is the proportional size of this accent band. Main panel faces and accents are edge-butteted and bonded to a single piece of substrate to form each individual wall panel.

Series 1000-A

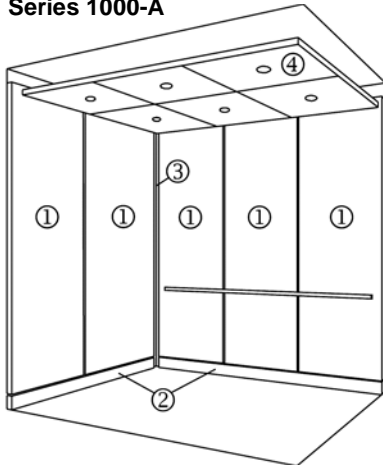

- ① Main panels
- ② Base
- ③ Corner reveals
- ④ Ceiling



Example shown – Main Panels: Stainless Steel, Sandstone finish; Circle pattern; Handrail: Compass Series.

Series 1000-B

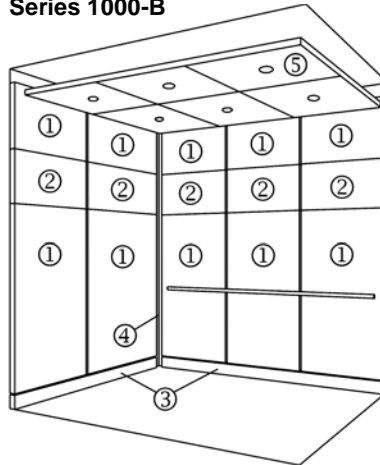

- ① Main panels
- ② Accent areas
- ③ Bases



Example shown – Main Panels: Stainless Steel, Sandstone finish; Accent Area: Stainless Steel, Ice finish, Tech pattern; Handrail: Tubular Series.

Series 1000-C

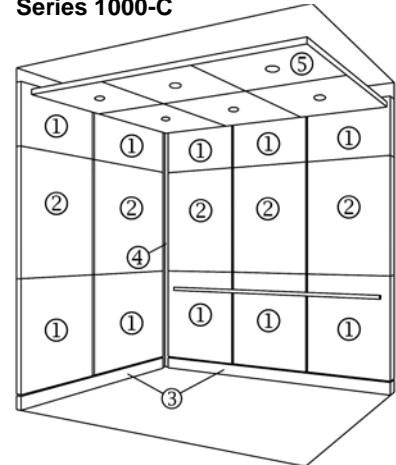

- ① Main panels
- ② Accent areas
- ③ Bases
- ④ Corner reveals
- ⑤ Ceilings



Example shown – Main Panels: Stainless Steel, Sandstone Random finish; Accent Area: Stainless Steel, Sandstone finish, Square pattern; Handrail: Classic Series.

Note: Because different computers, monitors and printers will render colors differently actual finishes may vary slightly from colors shown.

Typical Series 1000 wall panel detail shown in cross-section

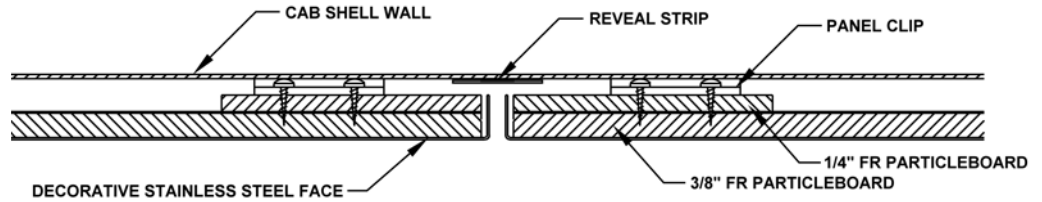

Wall Panels

Wall panels consist of stainless steel decorative faces bonded to a fire-rated particleboard substrate. The substrate includes an aluminum backer for enhanced panel stability. Total panel thickness including attachment system is a nominal 15/16".

Bases

A 4" high base is fitted between the finished floor and the wall panels. Bases consist of stainless steel decorative faces applied to a fire-rated particleboard substrate with aluminum backer.

Reveals

90° angled stainless steel reveals are supplied for the cab rear corners; flat stainless steel reveal strips are supplied for front corners and for the areas between adjoining panels.

Delivery

Wall panels, bases, reveals, and handrails for each individual cab arrive in a single crate, making it easy to organize materials on-site (ceilings, if specified, are crated separately). The crate arrives with components neatly organized and includes all the necessary fasteners, adhesives and templates along with easy-to-follow installation instructions.

Wall Panel Installation

Designed for quick installation, Series 1000 uses a system of extruded aluminum mounting clips that come pre-installed on the wall panels. Mating clips are field-attached to the cab shell interior using the included templates for easy vertical alignment.

Panel Replacement

If wall panels are ever damaged due to accident or vandalism, replacement panels can be ordered from Forms+Surfaces. The attachment system permits quick field repairs with minimal downtime.

Cab Shell Compatibility

Series 1000 interiors can be specified for cabs of just about any size, weight capacity or door configuration. Most interiors are installed in steel cab shells, but CabForms panels can also be supplied with appropriate screws for installation in wood shells if required. Most cab shells are found to be out-of-square to some degree. The CabForms wall panels and reveals have sufficient tolerances built into them to easily accommodate the vast majority of out-of-square conditions or other dimensional irregularities.

Metal Finish Options

Stainless steel decorative faces for Series 1000 are available in ten standard finishes. In addition, a variety of three-dimensional patterns can be applied to the wall panels to add visual interest or to enhance functionality. Please refer to the *Architectural Metals Tech Brief* for finish swatches and additional information.

Standard Stainless Steel Finishes

- Satin
- Polished
- Seastone
- Sandstone
- Sandstone Random
- Linen
- Serpentine
- Ice
- Mist
- Random

Standard Three-Dimensional Patterns

- Circle 3/4" or 1" dia. round embossures
3" or 4" horizontal c.c.
3" or 4" vertical c.c.
- Square 3/4" or 1-1/2" square embossures
3" or 4" horizontal c.c.
3" or 4" vertical c.c.
- Tech 1/4" x 1" oval embossures
1-3/4" or 2" horizontal c.c.
3" or 3-1/4" vertical c.c.
- Dallas 3/8" wide linear fluted pattern
oriented vertically

Note: Not all patterns are available for all finishes. Patterns are not available for bases, reveals or ceilings. Please refer to each Series 1000 model's Design/Ordering Guide for specific options.

Ceiling

Series 1000 wall panels integrate easily with existing ceilings or you can specify a CabForms ceiling to complete your cab package. The standard CabForms ceiling for Series 1000 is a six-panel suspended island design with six low-voltage halogen downlights. A nine-panel version with nine lights is also available for special applications or to suit customer preference. Ceiling panels consist of stainless steel decorative faces applied to a fire-rated particleboard substrate with aluminum backer. Any of the standard stainless steel finishes listed on page two may be specified. Ceiling reveals are painted with black fire-rated intumescent paint.

Emergency Exit

The emergency exit can be placed anywhere in the CabForms ceiling as needed to line up with the exit opening in the cab shell canopy. The Design/Ordering Guide asks you to detail the exact placement and this information will be verified via the approval drawings.

Lighting

Each of the downlights is mounted in a black, cast metal housing 3" in diameter. Lamps are 12V/20W halogen with an aluminum reflector and code-compliant rubber coated lens. The lighting system includes a 12V power supply and wire harnessing with quick-disconnect terminals. Standard input voltage is 120VAC; 220VAC is also available. The power supply includes an electronic dimmer to adjust the lighting level. The lighting system comes completely pre-installed in the CabForms ceiling. Some installers prefer to relocate the power supply to the top side of the canopy and sufficient wire harness length to do this is included.

Note: Other lighting types including indirect perimeter lighting are available by special order. Please call for additional information.

Emergency Lighting

Emergency lighting can be specified as an add-on to the standard lighting system. The emergency lighting system incorporates an additional power supply with a battery to power the emergency lights in the event of a main power failure. The power supply includes an automatic battery charger, test switch, low battery voltage circuit and alarm terminals. The emergency lights themselves are small high-intensity lamps integrated into two of the standard downlight housings.

Ceiling Installation

The CabForms ceiling uses a side-mount installation system that attaches the ceiling to the upper side walls of the cab shell. This system makes the ceiling very easy to install and provides a generous range of adjustment to align the ceiling with the wall panels.

A canopy-mount option incorporating track-adjustable tie rods is also available for cab configurations not conducive to the side-mount standard.

Handrail Options

Optional handrails in a choice of four standard series can be specified for cab back walls and/or side walls. All handrails include shoulder bolts for attachment to the wall panels.

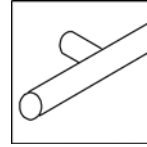
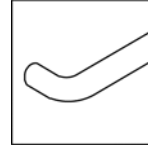

Tubular Series

1.25" diameter tubular rail with choice of radius bend ends or flat ends with integral standoffs

Tubular handrails are available in stainless steel or bronze with a choice of Satin, Polished or Stippled finishes. Rails and standoffs are always the same metal & finish.

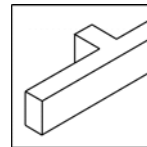

Classic Series

1" x 2" rectangular cross-section rail with integral standoffs

Classic handrails are available in stainless steel or brass with a choice of Satin, Polished or Stippled finishes. Rails and standoffs are always the same metal & finish.

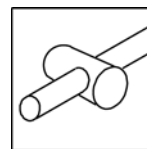
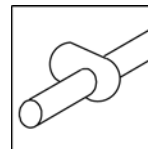

Compass Series

1.25" diameter tubular rail with choice of bullet-shaped or cylindrical standoffs

Compass rails and standoffs are available in stainless steel or bronze with a choice of Satin, Polished or Stippled finishes. Metals & finishes can be mixed or matched on rails and standoffs to create either uniform or contrasting effects.

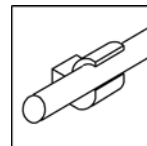

Modular Series

1.25" diameter tubular rail with L-shaped aluminum standoffs

Modular rails are available in stainless steel or bronze with a choice of Satin, Polished or Stippled finishes. Standoffs are always Clear anodized aluminum with Satin finish.

Series 1000 Weight Information

Series 1000 wall panels weigh approximately 3.3 lbs. per square foot. Ceilings (including lights and structural elements) weigh approximately 6.1 lbs. per square foot. Handrail weights vary by series and length. Estimated total weights for customer-specified cab interiors can be provided by Forms+Surfaces once shell dimensions, material selections and other system options are detailed in the Design/Ordering Guide.

Fire Ratings

Series 1000 backer materials and stainless steel face panels are all Class 1 fire-rated for smoke development and flame spread.

Ventilation

CabForms interiors are designed to accommodate most standard vent configurations. Unusual or non-standard ventilation requirements should be brought to our attention and detailed in the approval drawings to ensure compliance once material is installed.

Maintenance

Fingerprints and smudges can be removed from stainless steel surfaces using a non-chlorinated spray cleaner/degreaser such as Simple Green® (dry thoroughly with a soft cloth). Stainless steel's bright appearance can be maintained by occasional polishing with a soft cloth dipped in common household white vinegar. Commercial products specifically formulated for stainless steel such as 3M™ Stainless Steel Cleaner and Polish may also be used. Do not use harsh abrasives, acids or chlorine-based cleaners or cleaning tools containing carbon steel such as steel wool or wire brushes.

Custom CabForms

If your design requirements go beyond the standard Series 1000 configuration, material and finish offerings, customized versions are available for an additional charge. Call us to discuss your needs.

Additional Sheet Goods & Complementary Products

Sheet goods to match your cab interior are available for elevator doors, headers, jams, returns, lobby walls and other areas. Forms+Surfaces also manufactures a complete range of entrance doors, door pulls, railings, litter & recycling containers, site furnishings and other amenities—all in materials and finishes that complement those offered in CabForms.

Additional Information

A complete selection of CabForms support documents is available for download on the Forms+Surfaces web site:

- *CabForms Series 1000-A Design/Ordering Guide*
- *CabForms Series 1000-B Design/Ordering Guide*
- *CabForms Series 1000-C Design/Ordering Guide*
- *CabForms Series 1000 Installation Instructions*
- *CabForms Series 2000 Tech Brief*
- *CabForms Series 2000-A Design/Ordering Guide*
- *CabForms Series 2000 Installation Instructions*
- *CabForms Series 3000 Tech Brief*
- *CabForms Series 3000-A Design/Ordering Guide*
- *CabForms Series 3000-B Design/Ordering Guide*
- *CabForms Series 3000-C Design/Ordering Guide*
- *CabForms Series 3000 Installation Instructions*
- *CabForms Side Mount Ceiling Installation Instructions*
- *Architectural Metals Tech Brief*
- *Bonded Metal® Tech Brief*
- *CabForms Frequently Asked Questions*

All dimensions are nominal. Specifications subject to change without notice. For the most current version of this tech brief please visit our web site at www.forms-surfaces.com.

Code Compliances

Series 1000 wall panels, bases, handrails and ceilings comply with the following codes and guidelines:

ASME A17.1a-1997:**Safety Code for Elevators and Escalators, Section 204**

- 204.1b Securing of Enclosures (*Includes the requirements for the buffer test. CabForms components were tested successfully at 2g—twice the code requirement.*)
- 204.1e Top Emergency Exits
- 204.2a Material for Car Enclosures, Enclosure Linings, and Floor Coverings
- 204.2c Ventilation
- 204.2d Headroom in Elevator Cars
- 204.7d Protection of Light Bulbs and Tubes

2001 California Building Code, Chapter 30

- 3003.4.7 Car Inside*
- 3003.4.12 Handrails

Americans with Disabilities Act Accessibility Guidelines (ADAAG)

- 4.10.9 Floor Plan of Elevator Cars*

*Complies when installed in most common sizes of passenger cabs and service cabs. Purchasing party is responsible for ensuring that finished installation maintains minimum floor dimensions required by ADA guidelines and applicable local codes.

How to Specify

Design/Ordering Guides are available for each standard CabForms model to lead you through the specification process in a simple, checkbox format. The D/O Guide captures all the information needed to generate a quote: dimensions, finishes, handrail selections and other options. To get started, just give us a call.